

Meeting Planner

Rooms & Services are Specially Designed to Enhance Your Meeting Experience

- **Room Capacities** - 17 flexible meeting spaces to accommodate two to 400
- **Ergonomic Chairs** - comfortable, upholstered, with adjustable height, tilt and swivel
- **Generous Conference Tables** - hard writing surfaces and ample elbow room
- **Soundproof Stationary Walls** - no distractions or presentation interruptions
- **Separate Climate Control** - individually regulated settings for the right climate
- **Rheostat-Controlled, Parabolic Lighting** - adjustable to any illumination
- **Windowed Meeting Spaces** - open and airy rooms maximizing natural light
- **Dedicated Banquet Kitchens** - exclusive foodservice specific to each group
- **Continuous Refreshment Breaks** - freshly-brewed coffee, assorted beverages, fresh fruits, and pastries
- **Technical Support** - expertly trained, in-house staff on call
- **Complete Business Center** - for unexpected needs, last minute changes, or set-up your own office
- **Conference Planning Department** - full-time, conference planning manager to handle every detail of your meeting



Getting to Stowe, Vermont



By Air

Many major airlines service the Burlington International Airport with convenient direct flights from many cities. From the airport, Stowe is just a 40-minute drive. Limousine service and car rental are available at the airport.

Directions from I-89

Get off at Exit 10 and take Route 100 North into Stowe Village (about 10 miles). Turn left onto Route 108 North, the Mountain Road. Stoweflake Mountain Resort & Spa is less than two miles on the right.

Stowe... is a short drive away.

Boston-3 hrs, Hartford-3.25 hrs, Manchester, NH-2.25 hrs
Montreal-2 hrs, New York-5.5 hrs, New Jersey-5.5 hrs
Portland, ME-3.75 hrs



1746 Mountain Road, P.O. Box 369, Stowe, VT 05672 USA

800-253-2232 • 802-253-7355 • Fax 802-253-6858

UK Freephone 0500-892-522

info@stoweflake.com

www.stoweflake.com

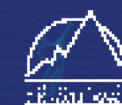

Member
International Association
of Conference Centers

Name	Dimensions	Sq. Feet	Ceiling Height	Theater	Classroom	U-Shape	Hollow Square	Banquet
PINNACLE	48 X 93	4464	12 ' 6 "	400	250	110	125	375
PINNACLE A	48 X 31	1488	12 ' 6 "	130	80	40	45	110
PINNACLE B	48 X 31	1488	12 ' 6 "	130	80	40	45	120
PINNACLE C	48 X 31	1488	12 ' 6 "	130	80	40	45	120
COLLINS		2600	12 ' 6 "		RECEPTION FOR UP TO 250			
GALLERY		640	CATHEDRAL		REGISTRATION AREA			
STOWE	60 X 43	2580	12 '	250	150	65	80	220
STOWE NORTH	43 X 31	1333	12 '	130	70	33	40	100
STOWE SOUTH	43 X 29	1247	12 '	120	65	30	30	90
BEATRICE	36 X 27	972	12 ' 6 "	60	40	25	35	70
ATRIUM	37 X 50	1880	CATHEDRAL	120	RECEPTION FOR UP TO 250			
ATRIUM LAWN		7000			LAWN/GARDEN RECEPTION & DINING			
STUART	26 X 27	702	8 '	50	35	20	30	
BUSINESS CENTER	16 X 16	260	8 '		COMPLETE BUSINESS CENTER & WORK STATION AREA			
MANSFIELD	30 X 16	480	8 '	50	30	20	25	50
GREEN MOUNTAIN	57 X 25	1425	8 ' 6 "	120	65	50	60	100
GREEN MOUNTAIN A	30 X 25	750	8 ' 6 "	60	35	35	40	50
GREEN MOUNTAIN B	27 X 25	675	8 ' 6 "	55	30	30	35	45
EXECUTIVE BOARD ROOM	23 X 43	1000	8 ' 6 "		UP TO 22 FOR BOARD ROOM SETUP			
STERLING		875	8 '		BREAK AREA FOR UP TO 100 PEOPLE			
EXECUTIVE SUITES (7)		260	8 ' 5 "		MEETING FOR UP TO 10			
WINFIELD'S	62 X 24	1400	8 ' CATHEDRAL		MAIN DINING ROOM FOR UP TO 80			
CHARLIE B'S				PUB DINING, WINE BAR, LIVE ENTERTAINMENT FOR UP TO 150				
SPA POOLSIDE CAFE				PRIVATE RECEPTION FOR UP TO 200 (Seasonal)				
SKI HOUSE				4-BEDROOM, 2-LIVING ROOM FOR UP TO 15				

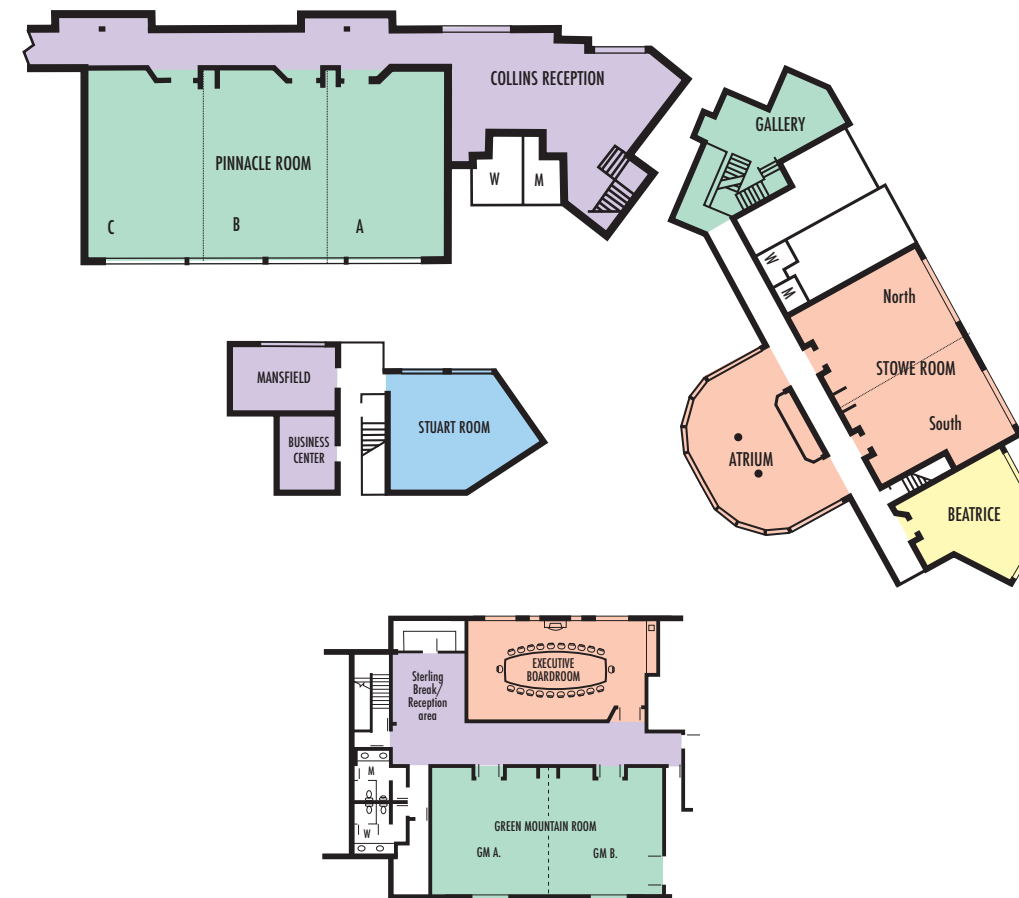
[illegible]

As Vermont's only IACC certified and AAA four-diamond conference center, StoweFlake can offer you the most complete meeting package: state-of-the-art facilities and a highly professional staff committed to hosting successful business meetings and memorable corporate functions.

Every group is assigned its own Professional Conference Planning Manager, an invaluable resource, to help your meeting proceed smoothly and successfully.

- Deluxe Room Accommodations
- Three Meals Daily from our Award-Winning Restaurants or our extensive and flexible banquet facilities
- Continuous Refreshment Breaks
- One General Session - 24-hour Dedicated Meeting Room Set to your Specifications
- Standard Audio-Visual Equipment
- Professional Conference Planning Manager
- Access to On-Premise Recreation, including the Sports & Wellness Center
- Around-the-Clock Conference/Concierge Service.